

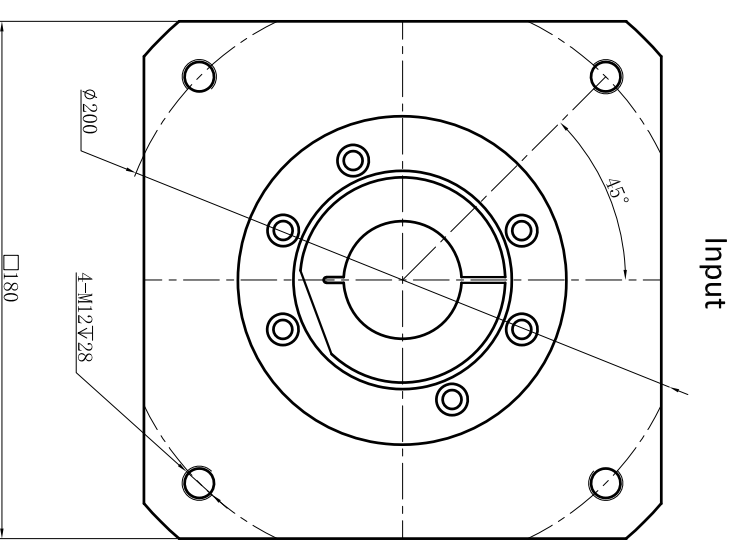

Customer name:

Output

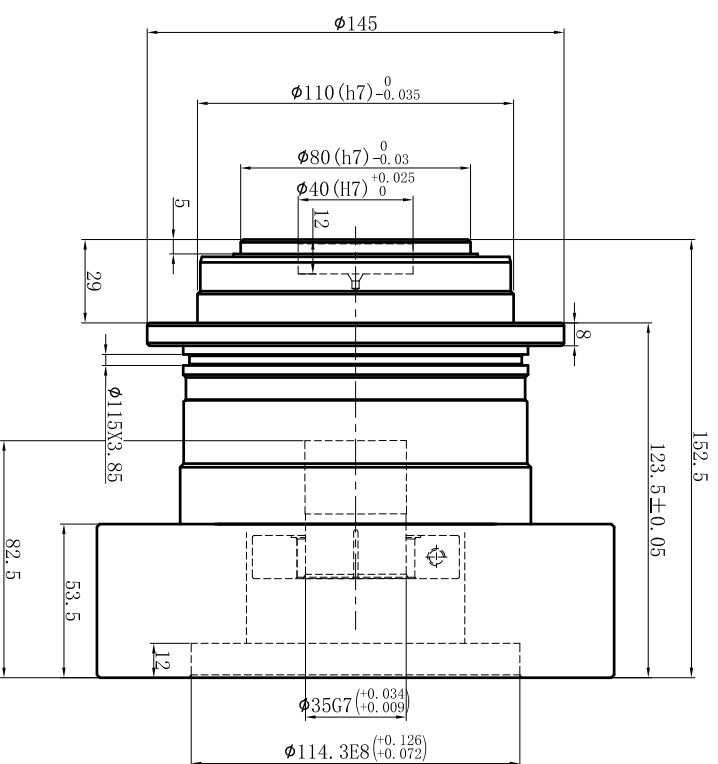
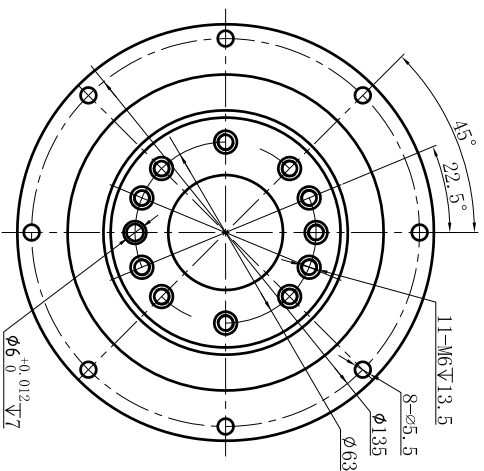

Transmission ratio	(<u>A</u>):1	Mass moments of inertia	(<u>B</u>)Kg.cm ²											
Rated output torque	(<u>C</u>)Nm	Max.Output torque	(<u>D</u>)Nm											
Rated input speed	4000rpm	Max input speed	8000rpm		10	2.57	235	423	Sign/Date					
Max.radial force	-	Max.axial force	2990N		7	2.62	300	540						
					5	2.71	333	599						
					4	2.87	290	522						
Efficiency	≥ 97%	Operating temperature	-20°~+90°	Ratio	A	B	C	D		Ratio	A	B	C	D
Mounting position	Any	Lubrication method	Synthetic grease	NOTE								Precision Planetary Reducer	TD110	
Weight ±3%	5.9Kg	Service life	20000h											
Standard backlash	≤ 5 arcmin	Protection class	IP65										TD110-L1	
Motor power		Noise level	60dB										Shaft Type	Precision
Motor dimensions														

Above specifications are for standard reducer and may be subject to change without notice.