

Customer name:

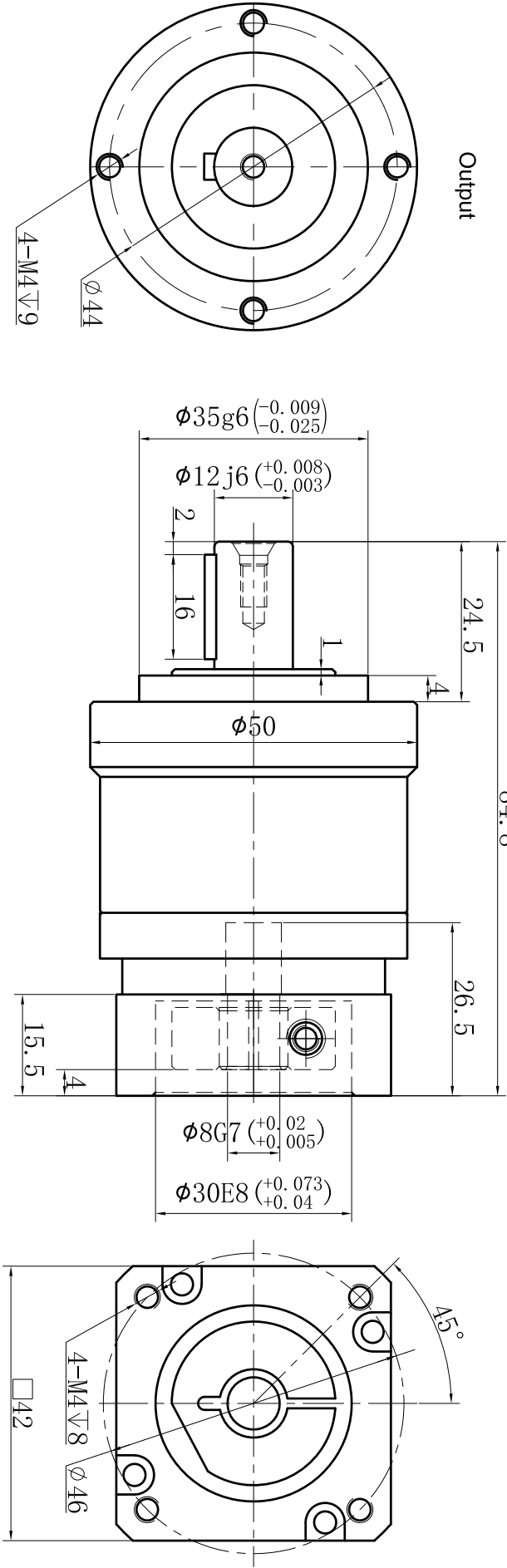

| | | | |
|---------------------|---------------------|-------------------------|-------------------------------------|
| Transmission ratio | (<u> A </u>):1 | Mass moments of inertia | (<u> B </u>) Kg.cm ² |
| Rated output torque | (<u> C </u>) Nm | Max. Output torque | (<u> D </u>) Nm |
| Rated input speed | 5000rpm | Max input speed | 10000rpm |
| Max. radial force | 702N | Max. axial force | 390N |
| Efficiency | ≥ 97% | Operating temperature | -20°~+90° |
| Mounting position | Any | Lubrication method | Synthetic grease |
| Weight ±3% | 0.6Kg | Service life | 20000h |
| Standard backlash | ≤ 5 arcmin | Protection class | IP65 |
| Motor power | | Noise level | 56dB |
| Motor dimensions | | | |

| | | | | | | | | | |
|-------|------|----|----|---|-----------|---|---|---|---|
| Ratio | A | B | C | D | Ratio | A | B | C | D |
| 10 | 0.03 | 14 | 25 | | Sign/Date | | | | |
| 7 | 0.03 | 19 | 34 | | | | | | |
| 5 | 0.03 | 20 | 36 | | | | | | |
| 4 | 0.03 | 19 | 34 | | | | | | |

NOTE

| | | | | | |
|------|-----|------|------|-----------------------------|-------|
| Mark | No. | Sign | Date | Precision Planetary Reducer | TE050 |
| DRAW | | | | | |
| CHEC | | | | | |
| APPR | | | | | |
| RULE | | | | | |

TE050-L1

Shaft Type Precision

(Above specifications are for standard reducer and may be subject to change without notice.)