

Customer name:

Output

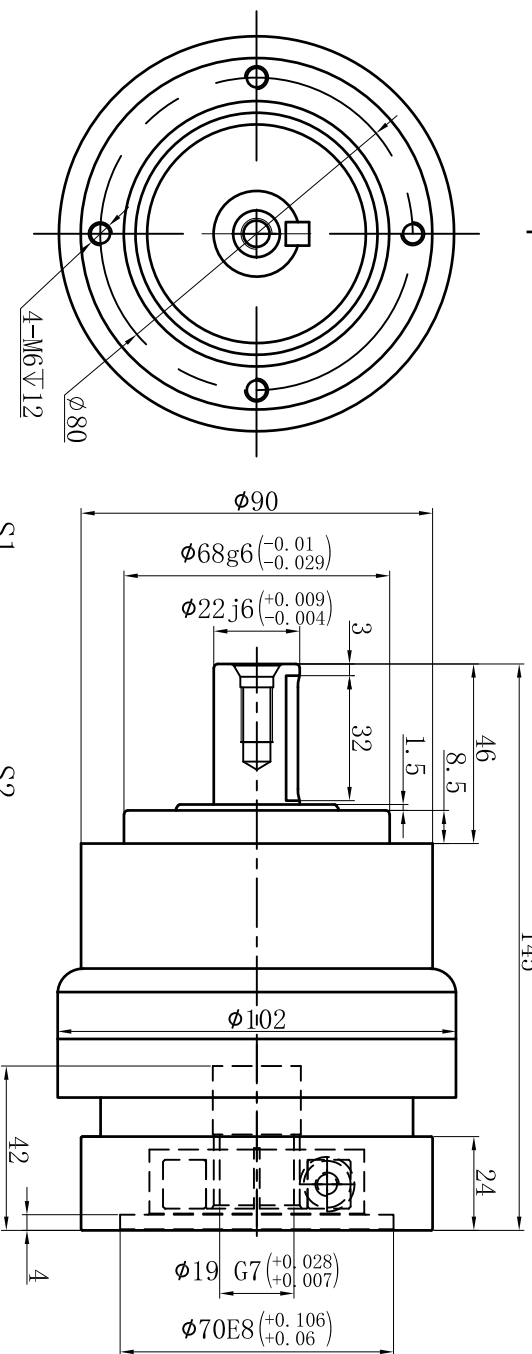

Input

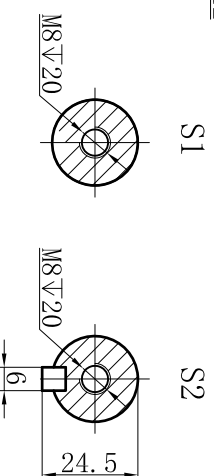
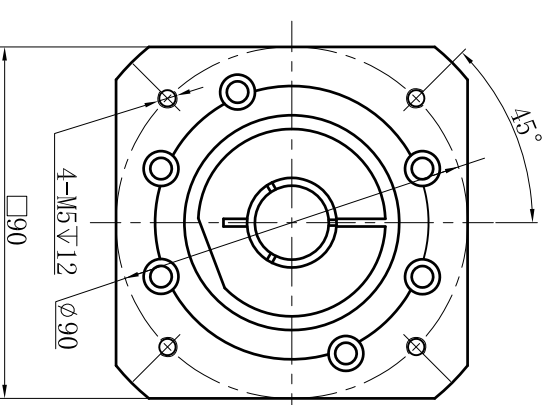

Transmission ratio	(<u> A </u>):1	Mass moments of inertia	(<u> B </u>)Kg.cm ²																
Rated output torque	(<u> C </u>)Nm	Max.output torque	(<u> D </u>)Nm																
Rated input speed	4000rpm	Max input speed	8000rpm			6	0.45	148	266.4	Sign/Date									
Max.radial force	2985N	Max.axial force	1625N			5	0.47	160	288				10	0.44	102	183.6			
						4	0.48	140	252				8	0.44	123	221.4			
						3	0.61	130	234				7	0.45	140	252			
Efficiency	≥ 97%	Operating temperature	-20°~+90°	Ratio		A	B	C	D			Ratio		A	B	C	D		
Mounting position	Any	Lubrication method	Synthetic grease	Note								Precision planetary reducer		TE090					
Weight ±3%	3.4Kg	Service life	20000h																
				Mark		No.	Sign	Date											
Standard backlash	≤ 5 arcmin	Protection class	IP65											TE090-L1					
Motor power		Noise level	60dB											Shaft Type		Precision			
Motor dimensions																			

